



# CONSORZIO ETERIA

COMPANY PROFILE

# ESTABLISHMENT OF THE CONSORTIUM

---

ETERIA was established on June 21st, 2021 .

Two of the main Italian industrial groups, the **Caltagirone family** and the **Gavio family** through Vianini Lavori and Itinera, combined their **industrial experiences** and skills in the implementation of complex **infrastructure projects** to operate in the **italian construction market** in the public and private sectors .

**A GOAL:**  
**THE COUNTRY'S INFRASTRUCTURAL  
RELAUNCH**



# THE EXPANSION OF THE CONSORTIUM

---

Over the years Eteria has expanded its corporate structure with the entry of two new partners:

- **ICOP**, company specialized in **underground engineering**, national leader for **microtunneling activities** with over 100 km of pipelines laid and also active in the **maritime works** and **civil engineering sector**.
- **SINELEC**, the technological company of the ASTM Group, develops **advanced technological systems** and transport infrastructures systems with the innovation power..



# SHAREHOLDERS OF ETERIA CONSORTIUM

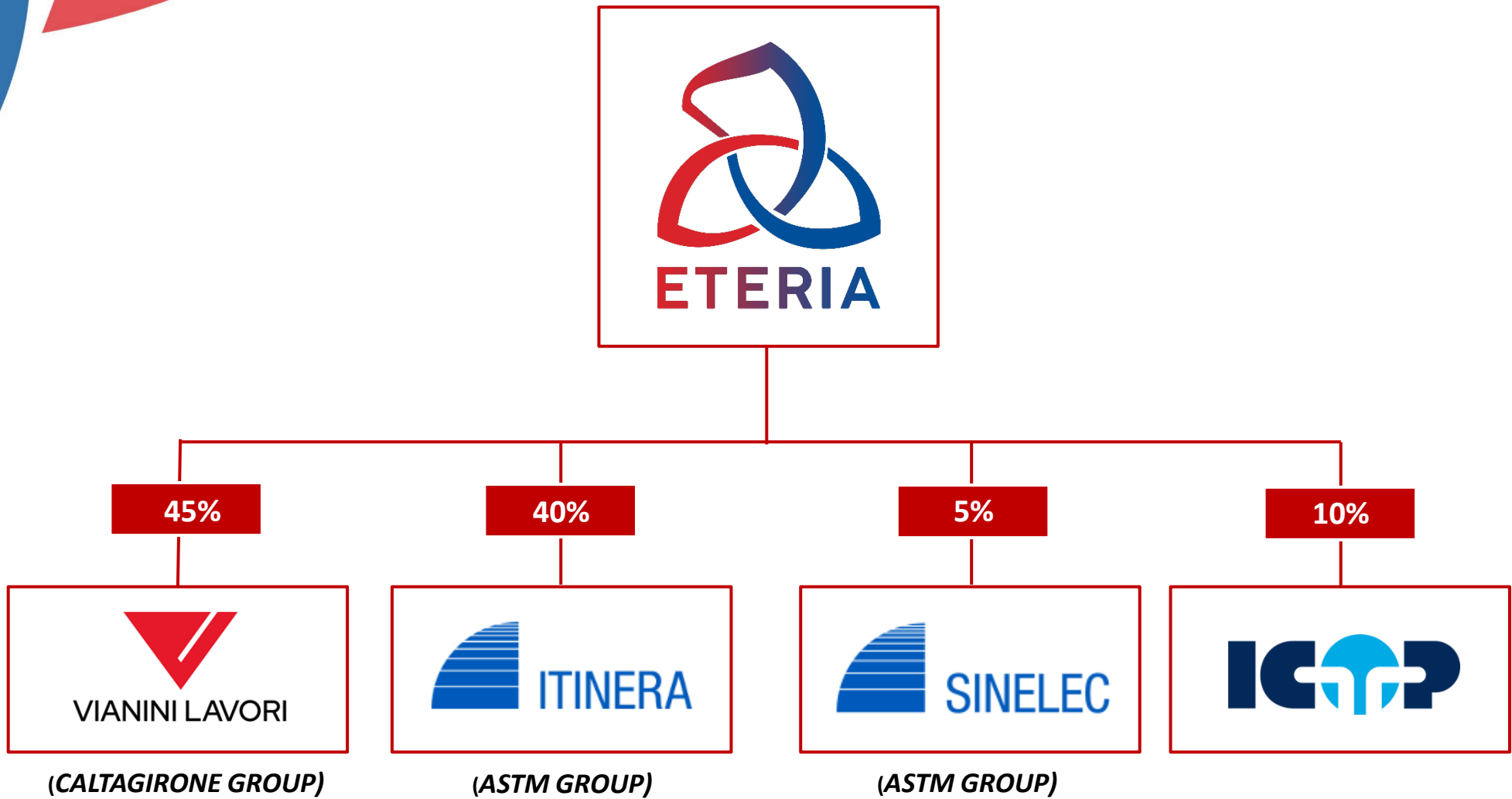

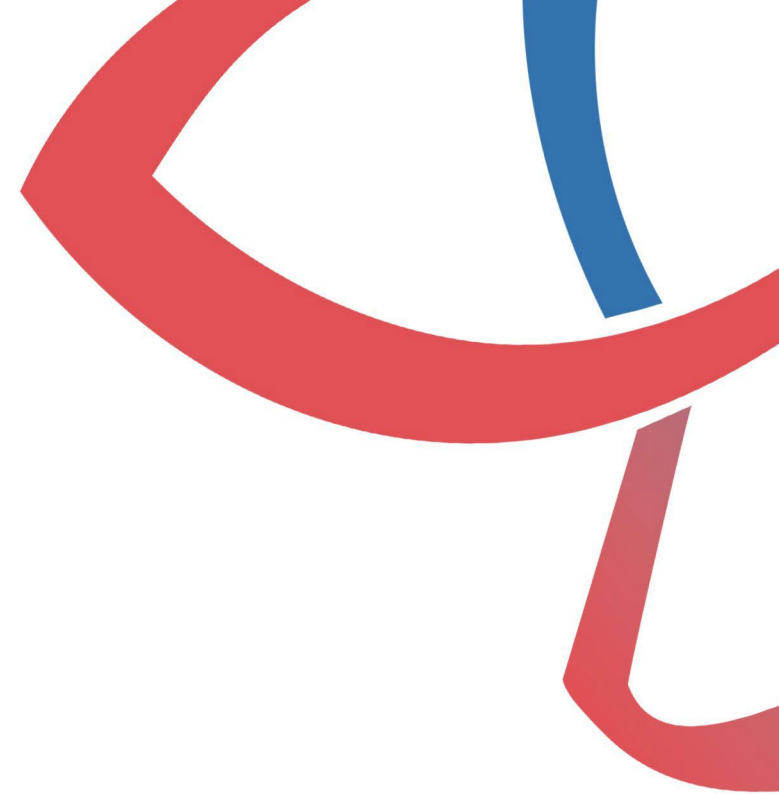

---

**ETERIA looks to the future and to the infrastructural relaunch of Italy, creating value and ensuring, thanks to the know-how and financial solidity of its members, ever greater competitiveness at the service of the country**

**A CONSORTIUM TO  
PLAN THE FUTURE**

# KEY NUMBERS

**2.3 bln**

**Partners Revenues  
(2023)**



**13**

**Contracts**



**2 Road infrastructures**

**6 Railway**

**2 Civil works**

**2 Hydraulic works**

**1 Maritime works**

**2.12 bln**

**Backlog**

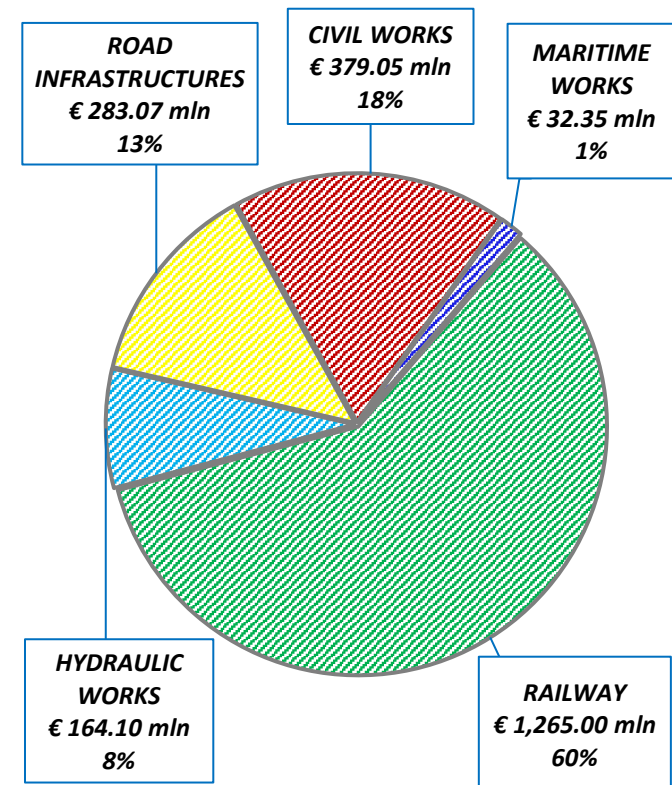

### S.S. 675 UMBRO-LAZIALE National Road – Monte Romano East-Civitavecchia: 1st section

Client: ANAS S.p.A.

JV: Consorzio ETERIA (70%) – VITTADELLO (18%) – EDIL MOTER (12%)

#### Description

In regards with the improvement of the infrastructural system connection of the port of Civitavecchia with the Orte intermodal hub, **Monte Romano east – Civitavecchia S.S. 675**, the contract includes the construction of the **1st section Monte Romano east – Tarquinia**, throughout the implementation of a new road section with separate carriageways, with 2 lanes in each direction, for a **total length of about 5 km**



**300 new employment**



**5 years duration works**



**4.6 km of new line**



**3 km of natural tunnel**



**400.000 cubic meters of excavation**

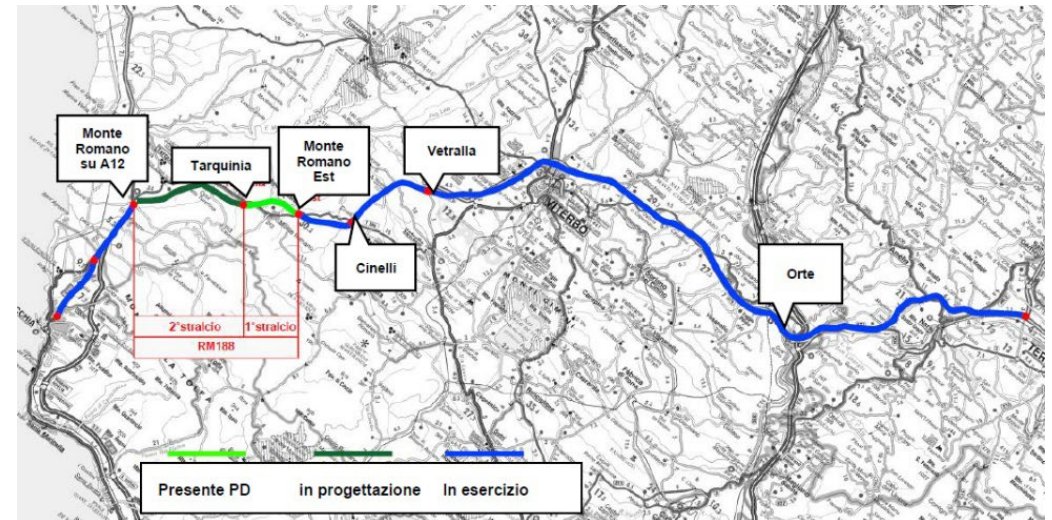

**Contract value**  
**252 mln €**

### S.S. 42 of the TONALE and the MENDOLA National Road – Variant East of Edolo

Client: ANAS S.p.A.

JV: Consorzio ETERIA (100%)

#### Description

The project involves the construction of a variant of the SS 42 national road, to bypass the town of Edolo, in the province of Brescia.

The road has a **total length of about 2 km** and includes the following works: **the EDOLO tunnel** (about 1.8 km long, about 1.4 km with natural excavation) and **the bridge over the river Oglio** (about 60 m long).



**4 years and 1 month** duration works



**2 km** road total length



**1** natural tunnel



**1** artificial tunnel

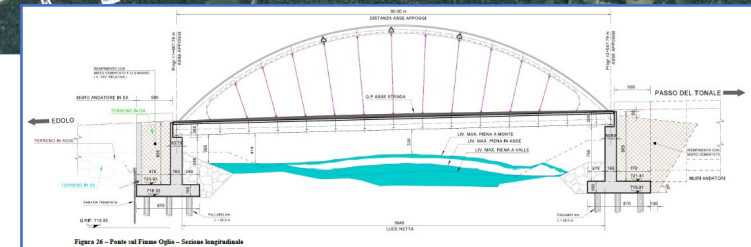

**Contract value**  
**107 mln €**



### CATANIA JUNCTION – Underground works of the railway line for airport runway extension

Client: **R.F.I. S.p.A.**

JV: **Consorzio ETERIA (91,80%) – EURO FERROVIARIA (7,81%) – SALCEF (0,39%)**

#### Description

Design and build of the railway line Messina–Catania–Palermo, **Catania junction** for the construction of **the railway station of Fontanarossa** and **the underground works of the railway line** due to the Fontanarossa airport runway extension, for a **total length of about 13 Km**



**450** new employment



**3 years** duration works



**11 km** of new line



**100,000 square meters** of diaphragms

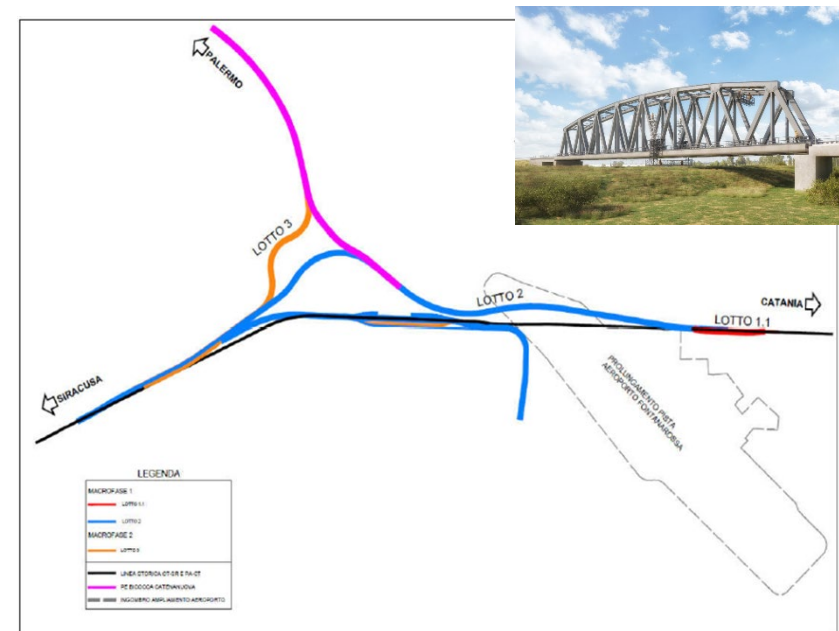

Contract value  
**370 mln €**

### ORTE-FALCONARA: Genga – Serra San Quirico railway section

Client: **R.F.I. S.p.A.**

JV: **Consorzio ETERIA (93,16%) – SALCEF (6,84%)**

#### Description

Construction works for the doubling of the **Genga-Serra San Quirico railway section on the Orte-Falconara line.**

The project involves the construction of **a new line of about 9 km**, of which 7 in variant and 2 in addition to the existing line. The works include **6 tunnels** (total length 5 km), **4 viaducts**, a new road, as well as the construction of a railway station in Genga, which will be the gateway to the tourist center of the Frasassi Caves.



**1 year and 10 months** duration works



**9 km** of new line



**1** new station



**6** natural tunnels for a total length of **5 km**



**4** viaducts



Contract value  
**374 mln €**

### SALERNO METRO – Completion works

Client: **R.F.I. S.p.A.**

JV: **Consorzio ETERIA (48,45%) - RCM (28,74%) - BRANCACCIO (10,76%) - GCF (12,05%)**

#### Description

Completion of the Salerno metro: Arechi - Pontecagnano Airport Costa d'Amalfi route".

The project consists in the completion of the Salerno metro, already in operation, with a further 9 km of electrified line and the activation of four new stops.



**140 new employment**



**3 years duration works**



**9 km of new line**



**100.000 square meters of diaphragms**



**4 new stations**



**4 viaducts**



**Contract value**  
**170 mln €**

# ROMA-PESCARA: Doubling of the Interporto d'Abruzzo - Manoppello railway section

Client: R.F.I. S.p.A.

JV: CONSORZIO ETERIA (90,73%,) – SALCEF (9,72%)

### Description

Design and construction of the doubling of the tracks for the Lots 1 and 2 of the Pescara-Roma railway line upgrading project. **The lot 1 regards the Interporto d'Abruzzo – Manoppello section** and consists in the line doubling for **approximately 5 km** close to the existing track and in the adaptation of Manoppello station with accessibility improvements.



**2 years and 5 months** duration works



**4,8 km** of new line



**3 viaducts**



**Contract value**  
**134 mln €**

# ROMA-PESCARA: Doubling of the Manoppello-Scafa railway section

Client: **R.F.I. S.p.A.**

JV: **CONSORZIO ETERIA (94,50%) – SALCEF (5,50%)**

### Description

Design and construction of the doubling of the tracks for the Lots 1 and 2 of the Pescara-Roma railway line.

The lot 2 regards the Mannoppello –Scafa section, and consists in the line doubling for approximately 8 km.



**2 years and 5 months** duration works



**8 km** of new line



**6 viaducts**



**Contract value**  
**315 mln €**

### ORTE-FALCONARA: Doubling of the PM228 – Albacina railway section

Client: R.F.I. S.p.A.

JV: CONSORZIO ETERIA (81,07%,) – SALCEF (18,93%)

#### Description

Doubling works for the PM228 – Albacina railway section, part of the Orte-Falconara line.

The project consists in the construction of, a **new railway track alongside the existing one which will extend for about 4 km** between the Movemente Station (km 228) and the Albacina station. It includes the removal of a level crossing, replaced by a modern subway, and improves the accessibility and safety of Albacina station.

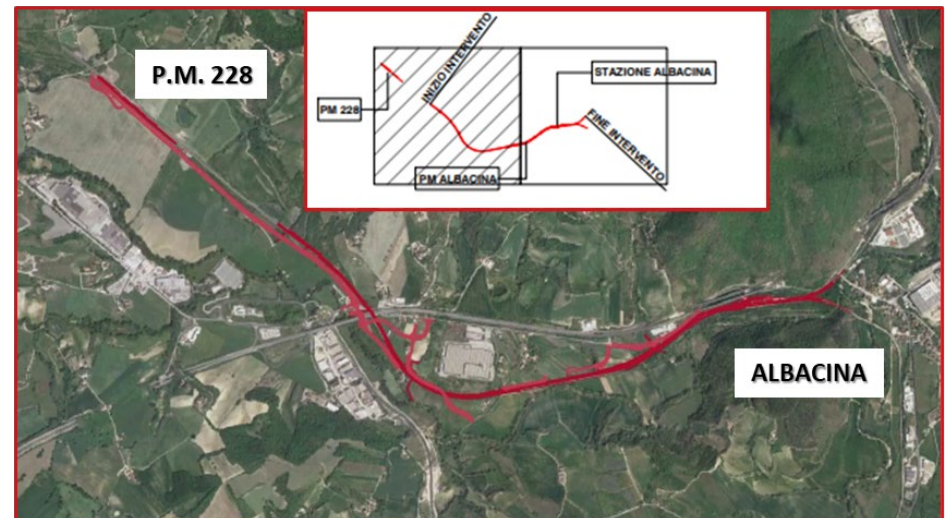

**1 year and 6 months** duration works



**3.9 km** of doubling works



Contract value  
**87 mln €**

## MSG ARENA – New Santa Giulia Arena in Milan

Client: CTS Eventim

JV: Consorzio ETERIA (100%)

### Description

Construction of the **new Santa Giulia Arena in Milan.**

The Arena will have a capacity of 16,000 people and is located in a plaza of more than 10,000 square meters, to serve the city of Milan for indoor and outdoor events.

The Arena includes 8 levels for a **total surface area of approximately 77,000 square meters.**



**250** new employment



**3 years** duration works



**16.000** people capacity



**10.000 square meters** of external place



Contract value

**322 mln €**

# MARCO POLO VENICE AIRPORT – Passenger terminal expansion - Lot 2A - Phase 1

Client: **SAVE S.p.A.**

JV: **Consorzio ETERIA (100%)**

### Description

Construction of the Lotto 2A - Phase 1 passenger terminal extension of Venice airport.

The project includes the expansion of the passenger terminal in the North side with a **new surfaces of approximately 14,300 square meters**, through the construction of a new volume and a temporary pier of connection to the existing terminal.

The new terminal expansion is distributed on 4 levels that contain: depots, new Schengen boarding halls on the front of the aircraft yard, arrivals, commercial and technical rooms serving public areas.

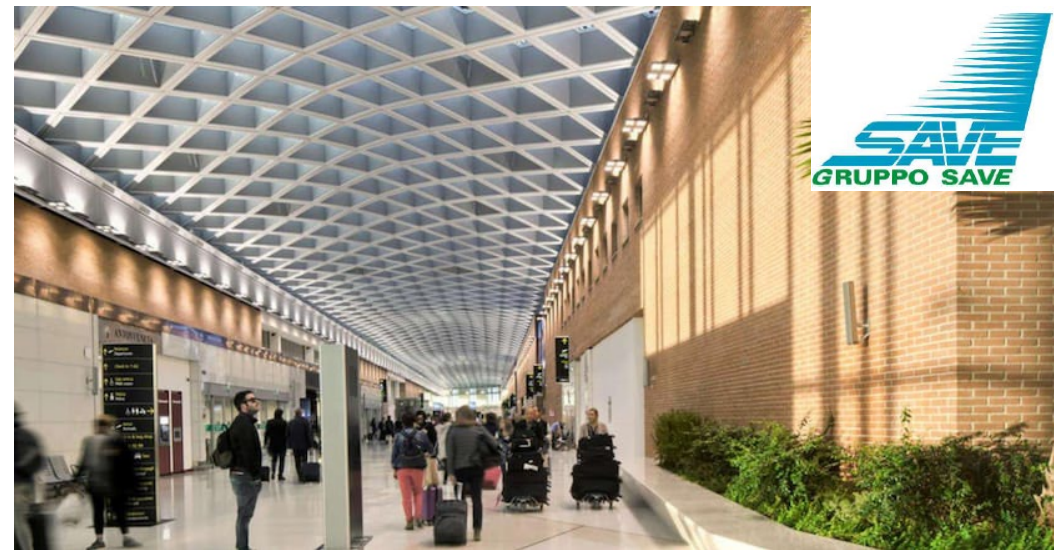

**2 years** duration works



**14,300 square meters** of expansion



**Contract value**

**57.3 mln €**



### NEW MARCIO AQUEDUCT – 1° Lot - Rome

Client: ACEA S.p.A.  
JV: Consorzio ETERIA (100%)

#### Description

First functional phase for the construction of an **aqueduct system new line** as part of the intervention of security and modernization of the Peschiera water system.

A new system of pipelines to be built in parallel to the two free surface tunnels part of the Marcio aqueduct, in the section between the original aqueduct and the Ceraso siphon

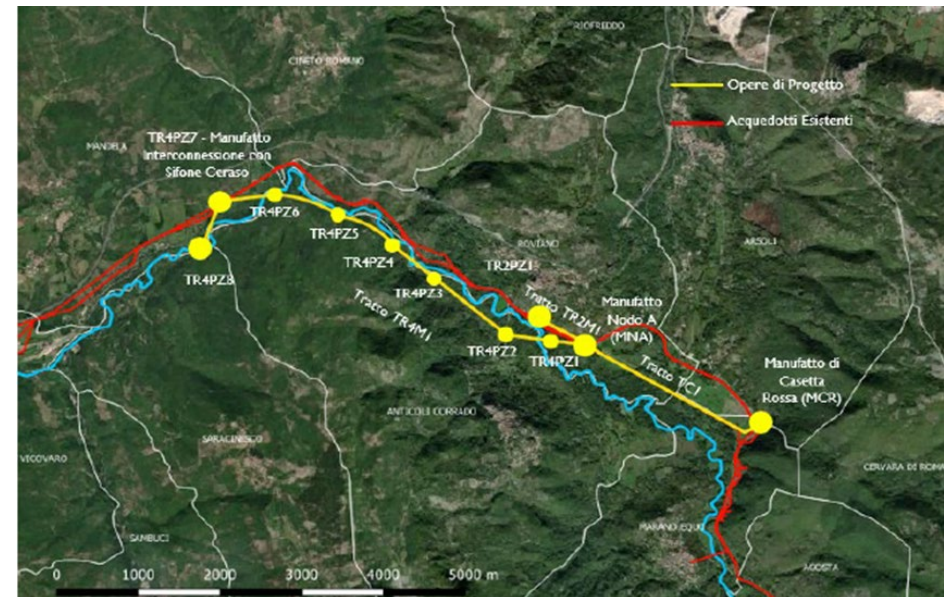

**2 years and 6 months** duration works



**2.3 km** double pipeline



**5.1 km** of pipeline



**Contract value**  
**127 mln €**

### OTTAVIA – TRIONFALE NEW PIPELINE

Client: **ACEA S.p.A.**

JV: **Consorzio ETERIA (100%)**

#### Description

The project includes the construction of a **new pipeline connection** from the Ottavia Water Center to a new Water Center called Pineta Sacchetti for a **total length of approximately 5 km**, in order to improve the reliability of existing facilities and ensure management alternatives for the city's water supply.



**2 years and 6 months** duration works



**5 km of pipeline**



**1 water center**



**330 m of microtunneling**

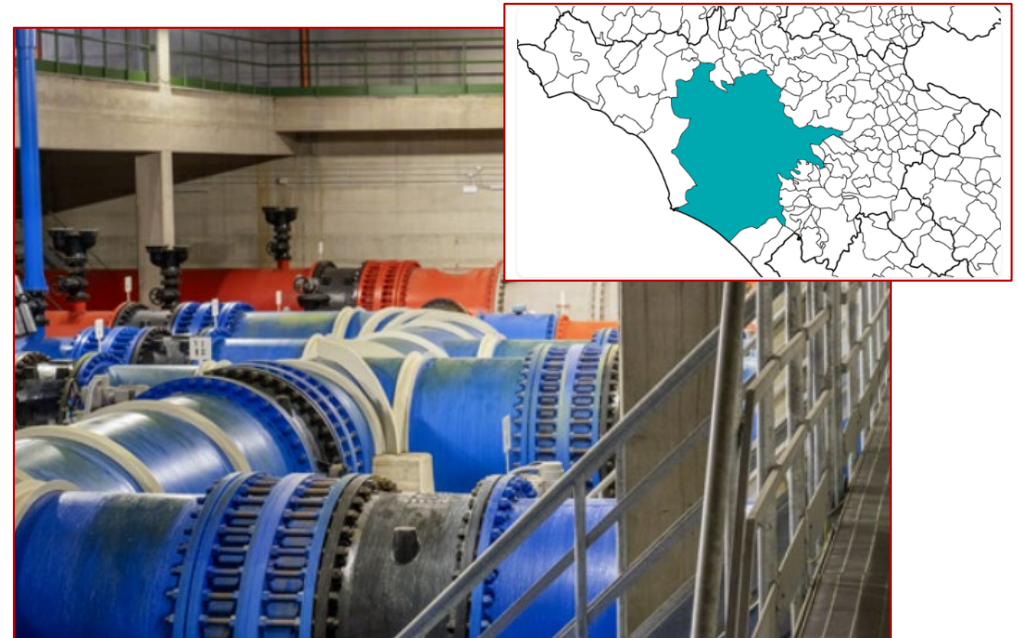

**Contract value**  
**74 mln €**

### MOLO VII - PORT OF TRIESTE – 1° Lot

Client: TRIESTE MARINE TERMINAL S.p.A.

JV: Consorzio ETERIA (100%)

#### Description

Construction of the **Molo VII extension - Port of Trieste - first lot.**

The extension will guarantee a **length of the South platform of approximately 870 m** of which approximately operating 810 m, to accommodate two ships mothers in contemporary. The new part of terminal will be able to assure the operativity of two platform cranes STS (Ship to Shore). The works will be carried out through a scaffold per day on drilled poles of large diameter.



**586 days** duration works



**870 m** south platform length



**Contract value**  
**32.3 mln €**



# REFERENCE MARKET

---

The consortium's strategy is to **exploit the synergies, experiences and references** of the members to face the Italian market of public and private works.

**RAILWAYS**

**METRO**

**ROADS**

**AIRPORTS**

**PORTS**

**HOSPITALS**

**Public Sector**

**UTILITIES AND  
INTEGRATED WATER  
CYCLE**

**BUILDINGS WITH  
HIGH  
TECHNOLOGICAL  
CONTENT**

**CIVIL, INDUSTRIAL  
AND COMMERCIAL  
BUILDINGS**

**Private Sector**

# OUR EXPERIENCE: **Railways**

**C.A.V. TO-MI**

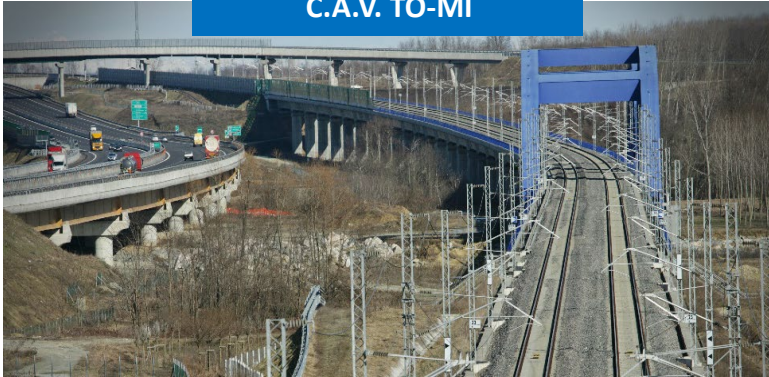

Construction of the High-Speed Railway Line TO\MI  
(Brandizzo – Agognate - Biandrate)

**ITINERA S.p.A.**

**T.A.V. S.P.A**



Construction works of Rome-Naples High Speed railway - Lots  
2.1 and 2.2. From Km. 84 + 434 to Km. 124 + 471

**VIANINI LAVORI S.p.A.**

**R.F.I. - Gruppo Ferrovie  
dello Stato S.p.A.**



Railway line crossing works (Treviglio - BG)

**I.CO.P. S.p.A.**

**FERROVIE NORD S.p.A.**



T1-T2 Railway connection – Milan Malpensa Airport

**ITINERA S.p.A.**

# OUR EXPERIENCE: **Railways**

**FERROVIE NORD S.p.A.**



Novara-Seregno Railway Line upgrade, Castano Primo – Turbigio section.

**ITINERA S.p.A.**

**CEPAV DUE**



Construction of the railway connection HS/HC, (Section Treviglio-Brescia)

**ITINERA S.p.A.**

**FERROVIE NORD S.p.A.**



Construction of the new rolling stock maintenance facility in Camnago

**ITINERA S.p.A.**

**RFI S.p.A.**

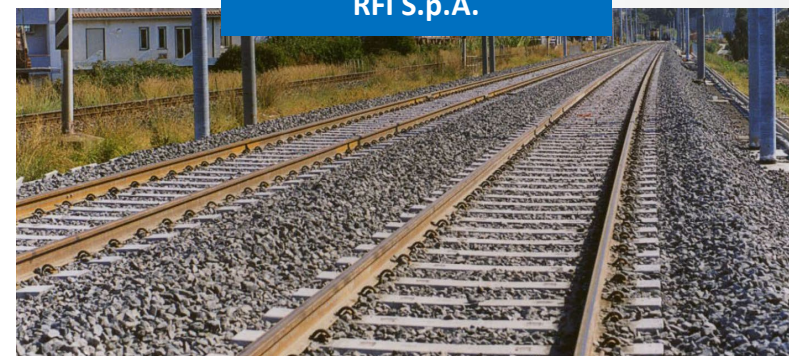

Double railway line Palermo –Messina (Cefalù)

**I.CO.P. S.p.A.**

# OUR EXPERIENCE: Metro

Metropolitana di Roma



Rome Metro New Line C - T3 Section

**VIANINI LAVORI S.p.A.**

Metropolitana di Napoli



Naples Metro – Line 1

**VIANINI LAVORI S.p.A.**

CMT

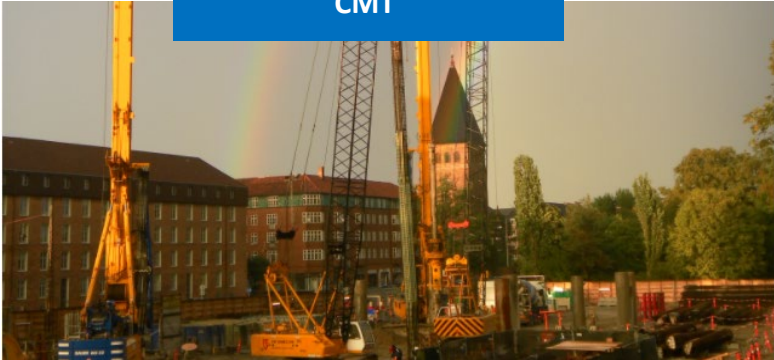

Cityringen Metro Project  
(Copenhagen – Denmark)

**I.CO.P. S.p.A.**

EIFPAGE GC RAZEL-BEC



Special Foundations – Paris Metro T2B  
Line 15 South (France)

**I.CO.P. S.p.A.**

# OUR EXPERIENCE: **Metro**

**Gruppo Torinese Trasporti S.p.A.**



Construction of driverless metro in Turin Lots 3 and 5 – Collegno-Porta Nuova stretch (tunnel 5,300 m)

**ITINERA S.p.A.**

**Regione Calabria**

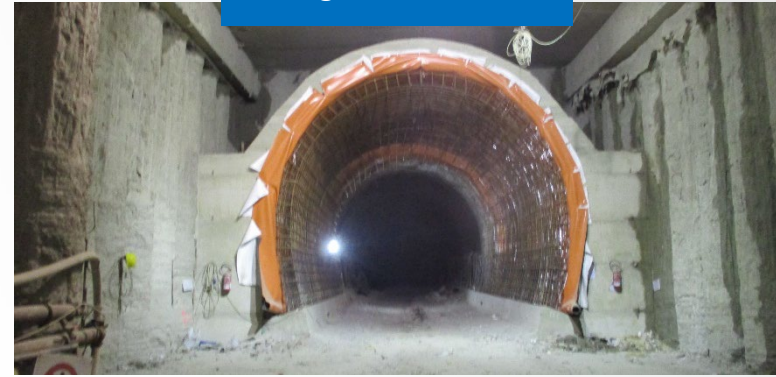

New Metropolitan System (*Catanzaro*)

**VIANINI LAVORI S.p.A.**

**EIFPAGE GC**



Special Foundations – Paris Metro Lot 1  
Line 16 (*Paris - France*)

**I.CO.P. S.p.A.**

**M.N. Metropolitana di Napoli S.p.A.**



Dante- Garibaldi Metro section,  
Piazza Dante Station and Montesano corridor – Line 1

**ITINERA S.p.A.**



# OUR EXPERIENCE: Roads

Brebemi S.p.A.



Highway Junction  
Brescia – Bergamo - Milan

ITINERA S.p.A.

Autostrade per l'Italia S.p.A.



Construction work on 2 lots of the A1  
motorway between Val di Sambro and  
Badia- Sasso Marconi  
(Sasso Marconi - Bologna)

VIANINI LAVORI S.p.A.

Asti-Cuneo S.p.A.



Asti-Cuneo Highway  
Lot 4.3 and Lot 5

ITINERA S.p.A.

Autovie Venete S.p.A.



1243 – Villesse-Gorizia motorway link

I.CO.P. S.p.A.

Comune di Alessandria

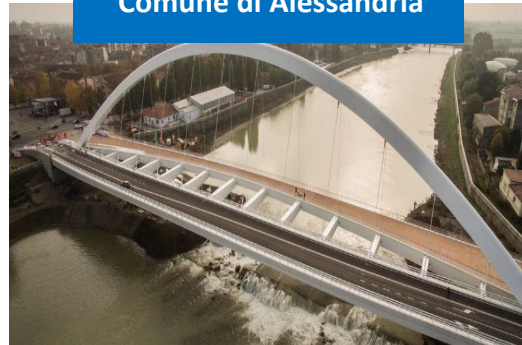

Ponte Meier construction -  
Alessandria

ITINERA S.p.A.

Pavimental S.p.A



Third lane enlargement of the Santa  
Lucia tunnel on the A1 Highway

EUROIMPIANTI S.p.A.

# OUR EXPERIENCE: Roads

A.T.I.V.A. S.p.A.

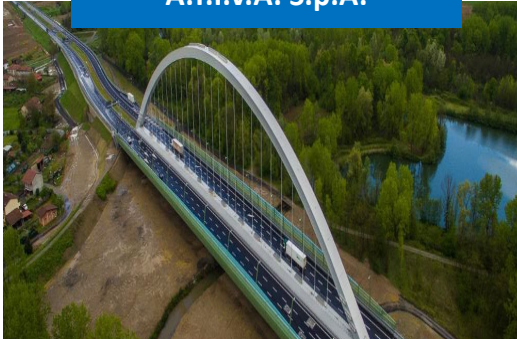

Rehabilitation of the Marchetti Viaduct-A4/A5 (Santhià-Ivrea)

ITINERA S.p.A.

ANAS S.P.A.



Gra Highway – North-West Quadrant - Adaptation to three lanes in each direction (Rome)

VIANINI LAVORI S.p.A.

SAV S.p.A



Adaptation works to the legislative decree 264/2006 for the A5 Turin-Aosta Highway

EUROIMPIANTI S.p.A.

PERGENOVA



Construction of Morandi Bridge - Genoa

I.CO.P. S.p.A.

C.A.L.



Construction of the External East Ring Road of Milan

ITINERA S.p.A.

SAT - Società Autostrada Tirrenica P. UN.



Completion works on the A12 motorway between Tarquinia-Civitavecchia (Lot 6a) – (Civitavecchia)

VIANINI LAVORI S.p.A.

# OUR EXPERIENCE: **Aiports**

**SAVE S.p.A.**



Rehabilitation runways, apron and hangar construction Marco Polo Airport Venice (Italy)

**ITINERA S.p.A.**

**Taranto Logistica S.p.A.**



Logistic platform, dock and pier extension - Taranto

**ITINERA S.p.A.**

**SACBO S.p.A.**



Enlargement Pax Terminal, Orio al Serio Airport - Orio al Serio (BG)

**ITINERA S.p.A.**

**Aeroporto Valerio Catullo di Verona Villafranca S.p.A.**



Upgrade of Terminal Catullo, Verona

**ITINERA S.p.A. / EUROIMPIANTI S.p.A.**

**S.E.A. S.p.A.**



Construction of the aprons, service roads, expansion of the terminal, construction of the ENAC building - Milan Malpensa Airport - Terminal 1

**ITINERA S.p.A.**

**Autorità Sistema Portuale Mare Adriatico Orientale**



Logistics Platform between the Timber Terminal and the former Italsider plant (Trieste)

**I.CO.P. S.p.A.**

# OUR EXPERIENCE: Hospitals



NYT Odense Universitethospital

Odense Hospital (Denmark)

ITINERA S.p.A.



I.F.O. Istituti Fisioterapici Ospitalieri

Construction works of the New S. Andrea Hospital building - 3 Lots - Rome

VIANINI LAVORI S.p.A.



Gruppo San Donato

Enlargement of the San Donato Hospital

ITINERA S.p.A.



Ospedale San Raffaele

The New Surgery and Emergency Hub - Via Olgettina (Milan)

ITINERA S.p.A.



Azienda Ospedaliera Mayer

Mayer children's hospital

ITINERA S.p.A.



GKSD EDILE S.P.A.

New Galeazzi Hospital - Milan

EUROIMPIANTI S.p.A.

# OUR EXPERIENCE: Utilities and Integrated water cycle

SAIPEM

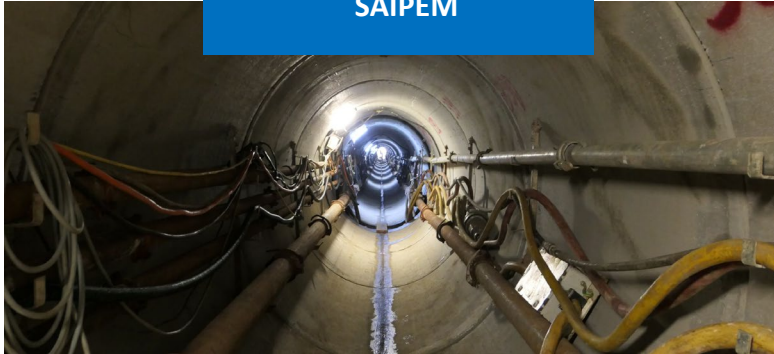

1365 - Gas pipeline *Trans Adriatic Pipeline* at Melendugno (Lecce)

I.CO.P. S.p.A.

SNAM RETE GAS



Construction of Direct Pipe and Microtunnel (*Cervignano – Mortara*)

I.CO.P. S.p.A.

E.A.A.P.

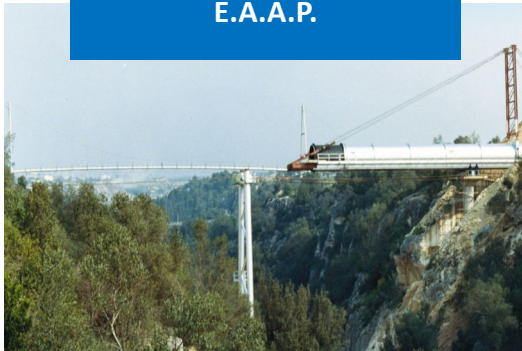

Works to supply water to the Sinni from the Monte Cotugno reservoir in Grottaglie – (Lecce)

VIANINI LAVORI S.p.A.

MMCES

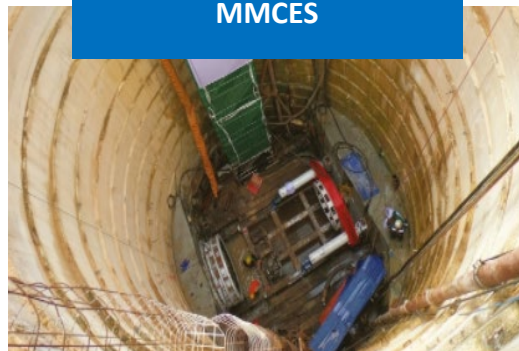

Construction of the Sungai Langat sewerage system, Kajang, Malesia

I.CO.P. S.p.A.

Provveditorato Interregionale per le Opere Pubbliche della Campania, Molise e Basilicata



Pavoncelli Bis Tunnel – Sele-Calore – Avellino Tunnel

VIANINI LAVORI S.p.A.

# OUR EXPERIENCE: Civil, industrial and commercial buildings

Fondo Erasmo

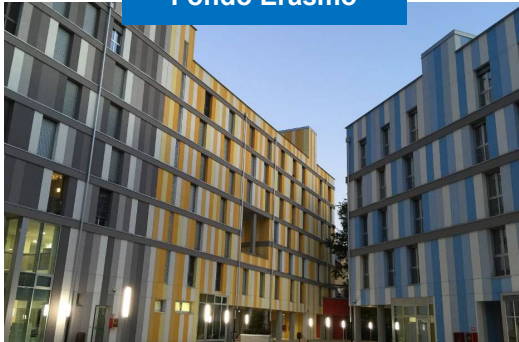

Construction of University Accommodation – Turin

ITINERA S.p.A.

Al Farwaniya Property



REEM Mall (Abu Dhabi - UAE)

ITINERA S.p.A.

Università di Torino



Construction of New Einaudi Campus (Law School and Political Science)

ITINERA S.p.A.

T.E.A. S.p.A.



Construction of Arese Mall (Milan)

ITINERA S.p.A.

Intesa San Paolo S.p.A.



Excavations, diaphragms and complementary works - New Intesa S. Paolo business centre (Turin)

I.CO.P. S.p.A.

Sviluppo Sistema Fiera S.p.A.



Design and construction works of the new Fiera Milano exposition centre.

VIANINI LAVORI S.p.A.

# OUR EXPERIENCE: Civil, industrial and commercial buildings

SEA S.p.A.



ENAC Building – Malpensa Airport

ITINERA S.p.A.

DHL EXPRESS ITALY S.r.l.



New building for DHL in the cargo city area – Malpensa Airport  
(Rozzano - MI)

ITINERA S.p.A.

Università di Tor Vergata



Tor Vergata University

VIANINI LAVORI S.p.A.

ROMA CRUISE TERMINAL  
SRL

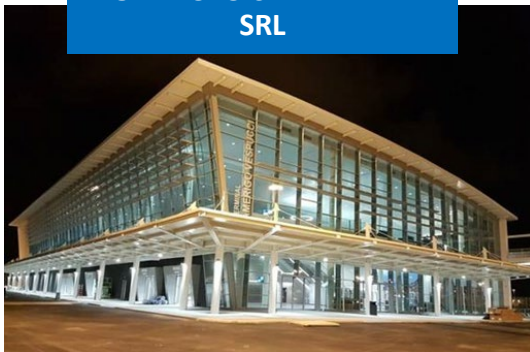

Amerigo Vespucci Cruise Terminal -  
Civitavecchia Harbor

ITINERA S.p.A.

SEA S.p.A.

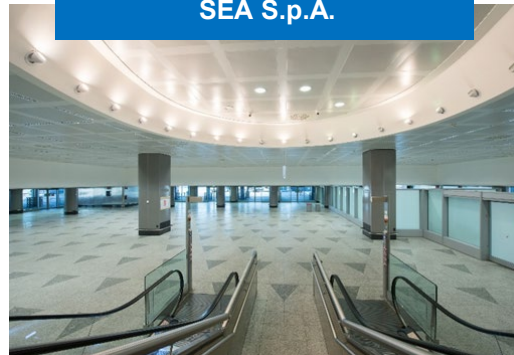

Railway station Terminal 2 – Malpensa  
Airport

ITINERA S.p.A.

Ministero della Giustizia



New Courthouse in Vicenza

ITINERA S.p.A.

# ETERIA Consortium Certifications

The ETERIA Consortium obtained the following certifications:

Quality  
**ISO 9001**

Environmental management  
**ISO 14001**

Health and Safety  
**ISO 45001**

Prevention of Corruption  
**ISO 37001**

Road Safety Management  
**ISO 39001**

Diversity and Inclusion  
**ISO 30415**

Social Accountability  
**SA 8000**

Gender Equality  
**UNI/PdR 125:2022**

Systema di Gestione Energia  
**UNI ISO 5001**

Approvvigionamento Sostenibile  
**ISO 20400**



**Ministero delle infrastrutture e della mobilità sostenibile**  
Direzione generale per la regolazione dei contratti pubblici e la vigilanza sulle grandi opere  
Sistema di Qualificazione Contraenti Generali

**ATTESTAZIONE DI QUALIFICAZIONE CONTRAENTE GENERALE**

Rilasciato al Contraente Generale: **ETERIA CONSORZIO STABILE SOCIETA' CONSORTILE A RESPONSABILITA' LIMITATA**  
Con sede in: **ROMA** CAP: **00187** Provincia: **RM**  
Indirizzo: **VIA LEONIDA BISSOLATI, 76** P.IVA: **16242941009**  
C.F.: **16242941009**

**Rappresentanti Legali**

Titolo Nome e Cognome	Codice Fiscale	Titolo Nome e Cognome	Codice Fiscale
Ing. Vincenzo ONORATO	NRTVCN74D25F839Z	Ing. Alberto RUBEONI	RIKJLR131C150792U

**Direttori Tecnici – Responsabili di Cantiere – Responsabili di Progetto**

Titolo Nome e Cognome	Codice Fiscale	Titolo Nome e Cognome	Codice Fiscale
Geom. Piergesio AGOSTI	GS1P0N39L12P205P	Geom. Renzo PRFVDFDILLO	PRVRNZ59T.23R36P
Ing. Paolo BASSI	BSSPA38T07L83G	Ing. Alfonso RATTI	RTTIANS68T09L463S
Ing. Alessandro LEFNCIONI	LENCIALSN6790M133F	Ing. Andrea RIGAZIO	RIGANDR757211.750Z
Geom. Mauro MIANIAS	MIANMIRA63M2LA357C	Ing. Pimio TAVERNA	TAVRPI.565M13A182Z
Ing. Vincenzo ONORATO	NRTVCN74D25F839Z		

**Organico Dirigenziale**

Numero Dirigenti in Organico	Classifica
65	III

**Classifica di qualificazione:**

Classifica	Importo
III	Oltre 700 M€

Il Contraente Generale possiede l'attestato SOA valido fino al 22/07/2026 rilasciato da SOA GROUP n. 25659AL/11/00.  
L'impresa possiede la certificazione (art.187,c.1 lett a) del D. lgs.12/01/2006 n.163) valida fino al 22/09/2024 - rilasciata da DNV GL Business Assurance Italy S.r.l.

L'impresa partecipa al Consorzio Stabile, con C.F.: ---

Attestazione n. **855/21** (n. progr. MIT) - Sostituisce l'attestazione n. (n. progr. MIT)

Data rilascio attestazione originaria	Scadenza validità
14/12/2021	13/12/2024

Data del rilascio attestazione in corso: 14/12/2021

**Il Dirigente Responsabile del Procedimento**  
(Dott. Geol. Fabio Faltelli)

**Firmato digitalmente da**  
**Fabio Faltelli**  
O = Ministero delle Infrastrutture e dei Trasporti

Documento sottoscritto con firma digitale e visionabile sul sito - <http://www.mit.gov.it/>



Code identificativo : 06689021007 (Autorizzazione n.11 del 09/11/2000)  
**ATTESTAZIONE DI QUALIFICAZIONE ALLA ESECUZIONE DI LAVORI PUBBLICI RILASCIATA AI SENSI DEL DPR 207/2010**

Rilasciato al consorzio: **ETERIA CONSORZIO STABILE SOCIETA' CONSORTILE A RESPONSABILITA' LIMITATA**  
con sede in: **ROMA** CAP: **00187** Provincia : **RM**  
Indirizzo: **VIA LEONIDA BISSOLATI 76** C.F. F. **16242941009** P. IVA: **16242941009**  
Iscritta alla CCIAA di: **ROMA** al n.: **16242941009**

**Rappresentanti legali:**

Titolo nome e cognome	Codice Fiscale	Titolo nome e cognome	Codice Fiscale
Gianni LUCIANI	LCNGNS4AD030Y		
Vincenzo ONORATO	NRVVCN74D25F839Z		

**Direttori Tecnici:**

Titolo nome e cognome	Codice Fiscale	Titolo nome e cognome	Codice Fiscale
Ing. Vincenzo ONORATO	NRTVCN74D25F839Z		
Arch. Luciano PUGLIESE	PGLLCN73D1FAS90R		
Arch. Achille PENZILLO	PNZICLL4099F9396		

**Categorie e classifiche di qualificazione:**

Cat.	Class.	C.F. direttore tecnico cui è commessa la qualificazione	Cat.	Class.	C.F. direttore tecnico cui è commessa la qualificazione
001	VIII	001	VIII	001	VIII
002	VIII	002	V	002	V
003	VIII	003	V	003	VIII
004	VIII	004	VIII	004	VIII-BIS
005	V	005	VIII	005	VIII
006	VIII	006	VIII	006	VIII-BIS
007	VIII	007	VIII	007	V
008	VIII	008	V	008	V
009	V	009	VIII	009	VIII
010	VIII	010	VIII	010	VIII
011	VIII	011	VIII	011	VIII
012	VIII	012	VIII	012	VIII
013	VIII	013	VIII	013	VIII
		014	I	014	VIII
		015	III-BIS	015	VIII
				016	VIII
				017	VIII
				018	VIII
				019	VIII
				020	VIII
				021	VIII
				022	VIII
				023	VIII
				024	VIII
				025	VIII
				026	VIII
				027	VIII
				028	VIII
				029	VIII
				030	VIII
				031	V
				032	VIII
				033	VIII
				034	VIII
				035	VIII

Qualificazione per prestazione di progettazione e costruzione fino alla VIII classifica.

Il consorzio possiede la certificazione (art. 3 c om. 1, lettera mm) D.P.R. 207/2010) valida fino al 22/09/2024 rilasciata da DNV BUSINESS ASSURANCE ITALY S.R.L.  
alla impresa codice fiscale: ---  
nella qualità di consorzio al Consorzio ETERIA CONSORZIO STABILE SOCIETA' CONSORTILE A RESPONSABILITA' LIMITATA

Partecipano al consorzio stabile: Eteria Consorzio Stabile Società Consortile A Responsabilità Limitata, con codice fiscale: 16242941009  
In seguito imprese ( indicare solo il codice fiscale )

Data	Rilascio attestazione originaria	Scadenza validità originale	Ingresso in corso	Rilascio attestazione in corso	Scadenza validità attestazione in corso
	22/07/2014	22/07/2014		22/07/2024	22/07/2024

Attestazione n.: **31801AL/11/00** (N.ro progressivo/Codice SOA) - Sostituisce l'attestazione n.: **29519AL/11/00** (N.ro progressivo/Codice SOA)

Data	Rilascio attestazione originaria	Scadenza validità originale	Ingresso in corso	Rilascio attestazione in corso	Scadenza validità attestazione in corso
	22/07/2014	22/07/2014		22/07/2024	22/07/2024

Copia del documento autenticato con firma digitale e archiviato nella banca dati dell'Autorità per la vigilanza sui lavori pubblici

Il legale rappresentante: **Guido CAMPREA** (firma) Il direttore tecnico: **Alessandro CIOTTI** (firma)





# **The members of the Consortium**

---



## ITINERA

---

**Itinera** is one of the main international players in the construction of **large infrastructural works and civil and industrial buildings**, as well as in the **development of concession projects and public-private partnerships.**



---

**Itinera** is one of the leading **Italian construction companies** in terms of size, revenues and order backlog.

---

Part of the **ASTM Group**, the second operator in the world of motorway networks under concession, Itinera is active in the construction of complex projects such as motorways, subways, railways, airports, viaducts, tunnels, works that accompany the lives of millions of people and become badges of the areas that host them.

---

ASTM is controlled by the **Gavio Group**, (Aurelia s.r.l. 50.5%) and by Ardian (49.5%), a private investment fund.

---

The company is a leader in the implementation of infrastructure projects and operates all over the world: **Europe, America, Middle East and Africa**

---

#### **Sectors of interest:**

Road and railway infrastructures, tunnels, underground works, dams and maritime works, civil construction (airports, hospitals, office and tertiary sectors, restorations and renovations), motorway maintenance, prefabricated buildings

---

Consolidated Revenues 2023:  
**€ 1.76 billion**

# ITINERA - Key numbers



**€ 1.76 billion**

Consolidated revenues 2023



**€ 7 billion**

Consolidated Backlog (dec. 2023)



**4,107**

Employees



**€ 970 million**

Revenues Itinera 2023



**€ 4.1 billion**

Itinera Backlog (dec. 2023)



**100+ km**  
Tunnel



**1000+ km**  
Roads and Railways infrastructures

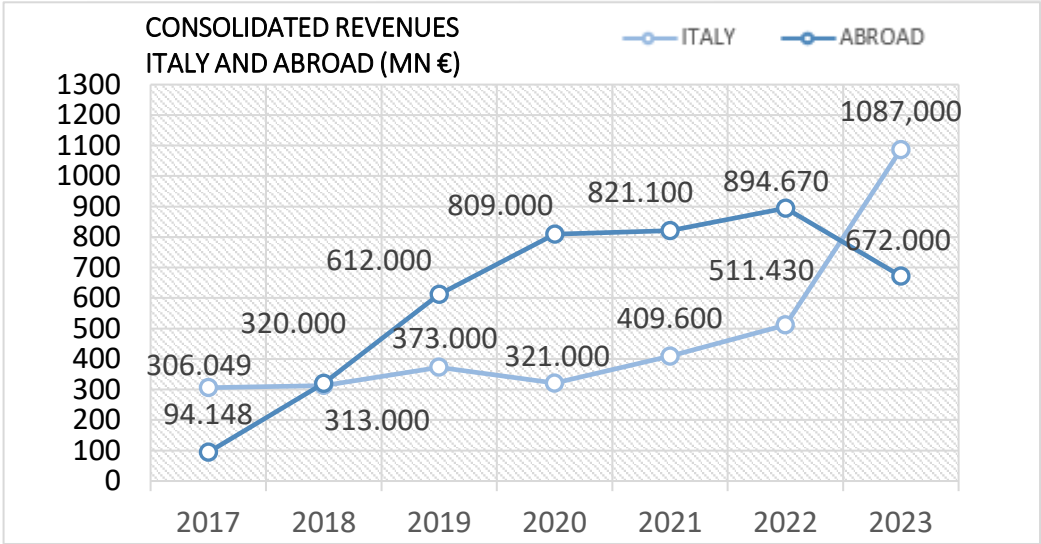
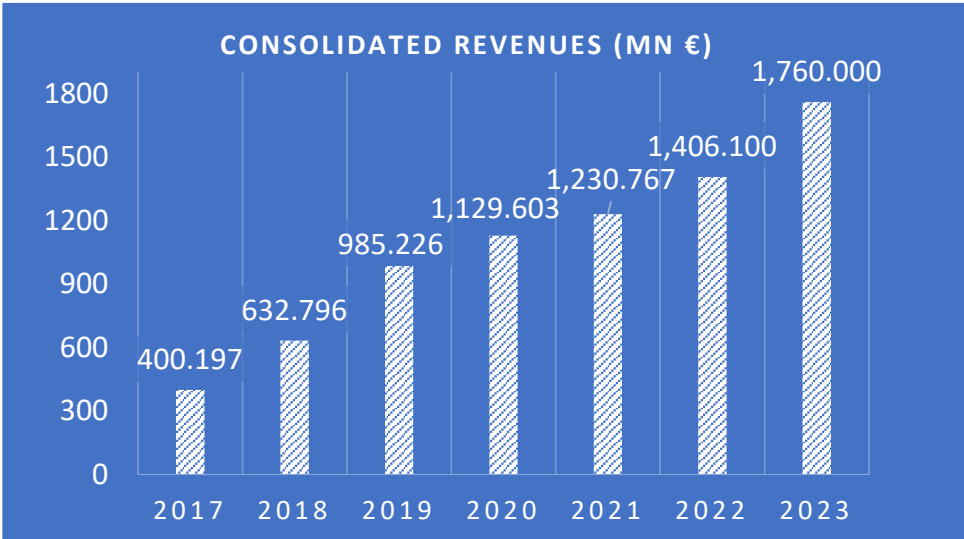



## SINELEC

---

**Sinelec** is the technology arm of the **ASTM Group**.

By combining the Group's technological and plant engineering skills, Sinelec develops advanced technological systems and plants for transport infrastructures, following the power of **innovation**.



---

**Sinelec** specializes in cutting-edge solutions for safe and intelligent traffic and transport infrastructures management. The company stands alongside road operators to face the challenges of future, more sustainable and connected mobility. Furthermore, Sinelec develops and manages high-tech mechanical and electrical systems for civil and industrial infrastructure and construction

---

**Sinelec** is part of **ASTM**, the world's second largest operator of motorway networks under concession and an international player in the design and construction of large infrastructure works..

---

ASTM is controlled by the **Gavio Group**, (Aurelia s.r.l. 50.5%) and by Ardian (49.5%), a private investment fund.

---

### Sectors of interest:

**Road and railway infrastructures**, ports and airports, **industrial, commercial and residential construction**, motorway maintenance, prefabricated buildings.

---

Aggregate Revenues 2023:

**€ 297 million**

# SINELEC – Key Numbers



**€ 297 million**  
Aggregate Revenues 2023\*



**€ 648 million**  
Consolidated Backlog (dec. 2023)\*



**604**  
Employees (dec. 2023)\*

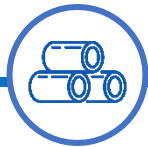

**+ 90 mln kg**  
Pipes installed in the last 5 years



**+ 2.000 km**  
Electric cables installed

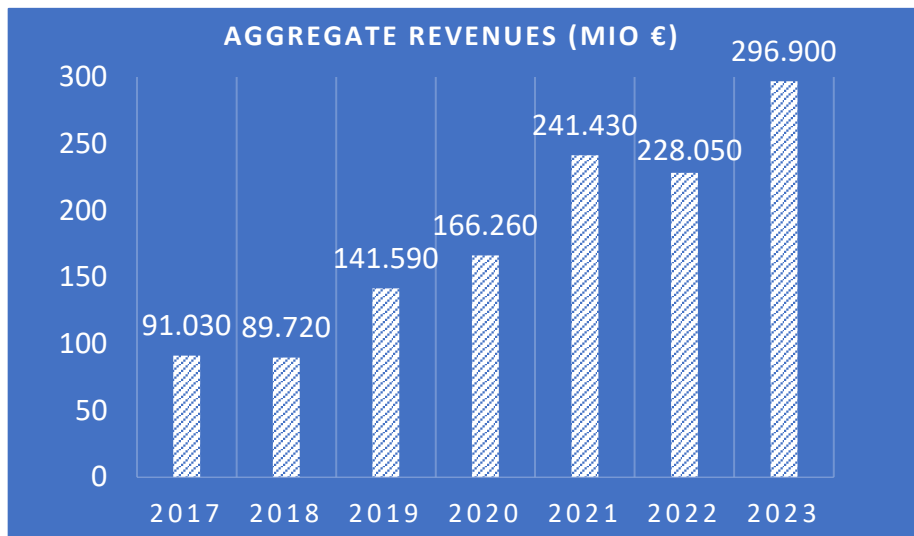

# ITINERA and SINELEC inside ASTM Group:







VIANINI LAVORI

# VIANINI LAVORI



**VIANINI LAVORI**  
is a company of the  
**Caltagirone Group**, one of the  
main Italian private industrial  
groups. It has been present for  
over a century in the most  
advanced sectors of civil  
engineering and construction in  
Italy and abroad.



---

As a General Construction Company, Vianini began its activity in the 1920s, acquiring and **carrying out important works both in the private sector and in public works, operating mainly in Europe, Asia, Africa and the American continent, creating over 2000 km of roads, 250 km of tunnels, 12 dams, 3000 km of aqueducts and irrigation pipes, 250 million cubic meters of dredging, 10 km of quays, 380 km of railways and subways, 130 bridges and viaducts and 6 airports.**

---

In 1984 Francesco Gaetano **Caltagirone took over the Vianini Group**, listed on the stock exchange, active in the sectors of major works and concrete products and with **a strong international presence.**

---

In the last 20 years, Vianini focused on the **Italian market** by carrying out, alone or in partnership, very important infrastructural works.

---

#### **Sectors of interest:**

Highways, dams, ports, aqueducts, tunnels, viaducts, civil and commercial construction.

---

Consolidated revenues 2023:

**€ 127.34 million**

# VIANINI LAVORI – Key Numbers

## CONSOLIDATED FINANCIAL STATEMENT 2023



**€ 127.34 million**

Revenues



**€ 5.94 million**

Profit



**€ 119.6 million**

Net Worth



**€ 148.47 million**

Net Debt



**0.939%**

Net Debt/Revenues

## REVENUES (mln €)

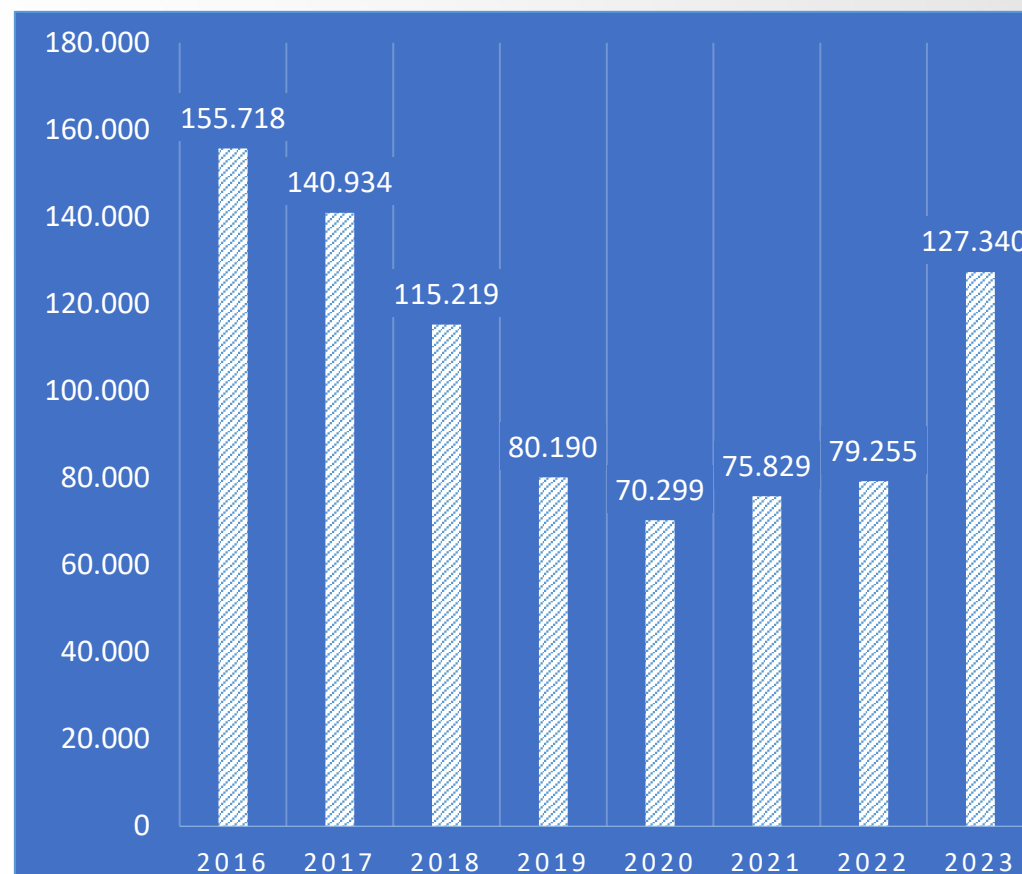



## ICOP Società Benefit

---

**ICOP**, controlled by the third generation of the Petrucco family, is today the **second national operator in the underground engineering sector and national leader for micro-tunnelling activities** with over 100 km of pipelines laid down, also active in the **maritime works and civil engineering sectors**.



---

**ICOP** is a leader in Italy and one of the main European companies in the microtunnelling sector, with branches in **Germany, Mexico and Malaysia**; it's very active in the Oil & Gas world, where punctuality and quality of service are required.

**ICOP** is the second Italian company in the field of special underground works, able to cover the entire range of special foundation and land consolidation works, with a stable and structured presence in **France** and in the **Scandinavian countries**.

**ICOP** has a highly qualified internal design studio capable of making available to Clients a wealth of **experience gained in over 100 years of activity**.

---

**ICOP** operates with its own yards in **25 countries**: from Mexico to Singapore, from Sweden to Colombia. In 12 of these states ICOP established branches with a stable presence on the markets for over 10 years.

---

### Sectors of interest:

Foundations and special underground works, micro-tunnelling and direct pipe, maritime works, road works: bridges, viaducts and underpasses.

---

Consolidated Revenues 2023:

**€ 117 million**

**1#**

National leader in the Micro-tunnelling segment and one of the main independent players in Europe

**2#**

Second national player in the special foundations market after Trevi and one of the main operators in Europe

# ICOP – Key Numbers



**€ 117 million**

Consolidated Revenues 2023



**€ 900 million**

Consolidated Backlog (dec. 2023)



**350**

Employees



**€ 93 milioni**

I.CO.P. revenues 2023



**€ 850 milioni**

I.CO.P. S.p.A. Backlog (dec. 2023)

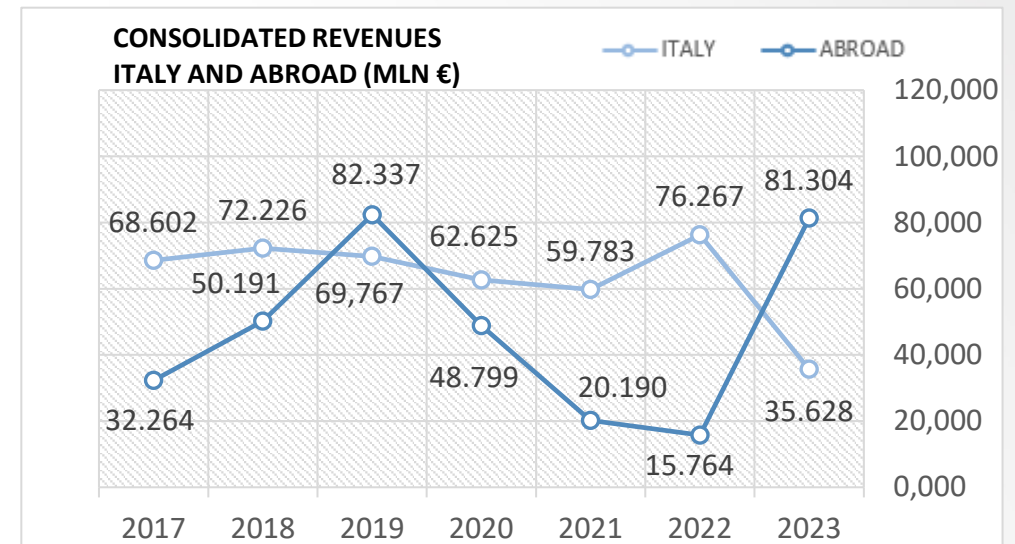
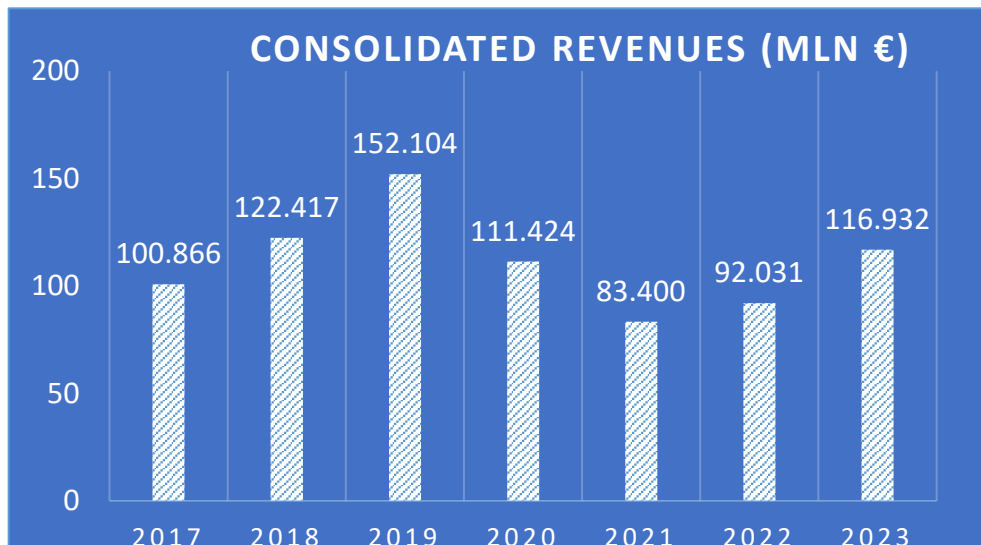

# CONTACTS

---



Consorzio Stabile Eteria  
Via Leonida Bissolati, 76 - Rome (RM) - Italy

Phone: (+39) 06 77610820

[info@consorzioeteria.it](mailto:info@consorzioeteria.it)